

# Fork Beams

## Models 5, 10 & 15 - Fork Lift Beams

Caldwell Fork Lift Beams are specifically designed to make fork lifts more versatile by providing positive handling of loads otherwise impractical for fork lifts.



### PRODUCT FEATURES:

- Easy attachment, no special wrenches or tools needed.
- Strong, sturdy, all welded construction.
- Easy to see, highly visible yellow paint.
- Custom designs available.

**INSTOCK PROGRAM**

**QUICKSHIP PROGRAM**

**WARNING**

Capacity of lift truck and attachment combination may be less than capacity shown on attachment. Consult lift truck manufacturer.

## Model 5 - Single Fork Hook - Fixed or Swivel



(Fixed hook shown)



(Swivel hook shown)

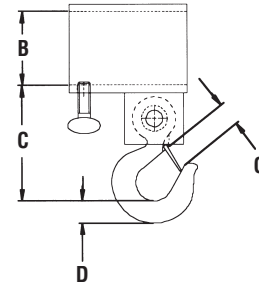
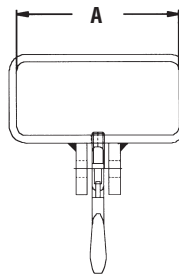

### SPECIFICATIONS

Model Number Fixed	Model Number Swivel	Rated Capacity (lbs.)	Dimensions (in.)						Weight (lbs.)
			A	B	C Fixed	C Swivel	D	O	
5-1 1/2-4	5S-1 1/2-4	3000	4-1/2	2-1/2	4-11/16	6-9/16	1	1	7
5-1 1/2-5	5S-1 1/2-5	3000	5-1/2	2-1/2	4-11/16	6-9/16	1	1	8
5-1 1/2-6	5S-1 1/2-6	3000	6-1/2	2-1/2	4-11/16	6-9/16	1	1	9

# Fork Beams

## Model 10 - Single Hook Beam - Fixed or Swivel



Model 10S-2-20



Model 10S-7.5-36

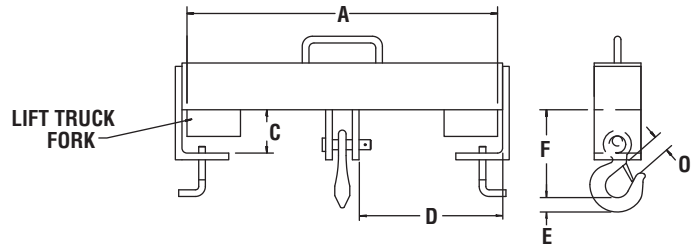

### SPECIFICATIONS

Model Number Fixed	Model Number Swivel	Rated Capacity (lbs.)	Dimensions (in.)							Weight (lbs.)
			A	C	D	Fixed F	Swivel F	E	O	
10-2-20	10S-2-20	4000	20	3-1/4	9-1/8	7-1/4	8-7/8	1-1/8	1-5/32	21
10-5-24	10S-5-24	10000	24	3-1/4	10-3/4	9-1/4	11-7/16	1-13/16	1-11/16	42
10-5-36	10S-5-36	10000	36	3-1/4	16-3/4	9-1/4	11-7/16	1-13/16	1-11/16	80
10-7.5-36	10S-7.5-36	15000	36	4-1/4	16-1/4	13-3/4	15-3/4	2-1/4	2-7/32	166
10-10-36	10S-10-36	20000	36	4-1/4	16	14-5/8	16-7/16	2-19/32	2-13/32	180
10-15-36	10S-15-36	30000	36	4-1/4	15-7/8	14-1/2	16-5/16	2-19/32	2-13/32	210

## Model 15 - Double Hook Beam - Swivel

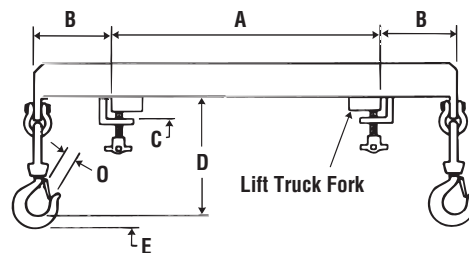
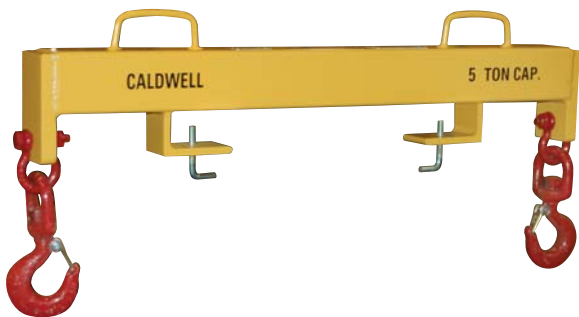

### SPECIFICATIONS

Model Number	Rated Capacity (lbs.)	Dimensions (in.)						Weight (lbs.)
		A	B	C	D	E	O	
15-2-20	4000	20	6-5/8	2-1/2	10-3/8	1-7/16	1-11/32	60
15-5-24	10000	24	9-3/8	2-1/2	11-21/32	1-7/16	1-11/32	68